

STRUCTURALLY CALCULATED ROOF CURB CBC COMPLIANT WITH IBC 2012, CBC 2013, ASCE/SEI 7-10

SELECT PRODUCT

CANFAB PART #	BASE CURB HEIGHT	APPROXIMATE SHIPPING WEIGHT
1005-CB08A-CBC	8"	121 LBS.
1005-CB11A-CBC	11"	130 LBS.
1005-CB14A-CBC	14"	139 LBS.
1005-CB18A-CBC	18"	151 LBS.

- - ROOF CURB IS MIN 16 GA. GALVANIZED STEEL.
- - FULL PERIMETER WOOD NAILER PROVIDED.
- - GASKET MATERIAL & ASSEMBLY HARDWARE PROVIDED.
- - TOP CORNERS ARE MITRED.
- - CURBS ARE SHIPPED KNOCKED DOWN.

CODE NOTE :
 THE CURB HAS BEEN DESIGNED FOR SDS=1.5G AS AGREED WITH THE CLIENT TO COVER MOST OF THE CA AREA FOR THE HIGH SEISMIC REGIONS WITH SDS>1.5G FURTHER ANALYSIS AND MODIFICATIONS ARE REQUIRED TO THE CURB PRIOR TO INSTALLATION.

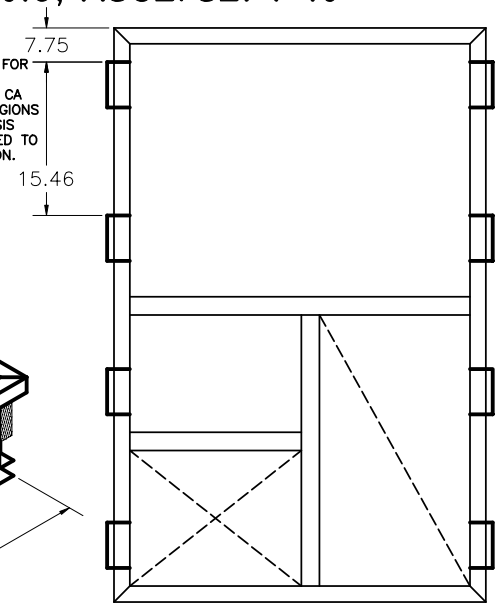

CURB PLAN

SELECT CONSTRUCTION

- A=STANDARD BOLT TOGETHER CONSTRUCTION (SHOWN ABOVE).
- E=STANDARD BOLT TOGETHER CONSTRUCTION EXTERNALLY INSULATED.
- F=FINGERLOCK CONSTRUCTION HEAVY GA. GALVANIZED STEEL (ONLY AVAILABLE ON 11" AND 14" MODELS).
- G=FINGERLOCK CONSTRUCTION EXTERNALLY INSULATED HEAVY GAUGE GALVANIZED STEEL (ONLY AVAILABLE ON 11" AND 14" MODELS).

ENGINEER OR RECORD SHALL PROVIDE SUPPORT STRUCTURE AND VERIFY THE ADEQUACY OF THE STRUCTURE FOR LOADS IMPOSED ON THEM BY UNIT AS WELL AS ALL OTHER LOADS, FOR ALL SHEET METAL FASTENERS, USE HILTI KWIK PRO SELF-DRILLING SCREW. INSTALL PER ICC ESR-2196

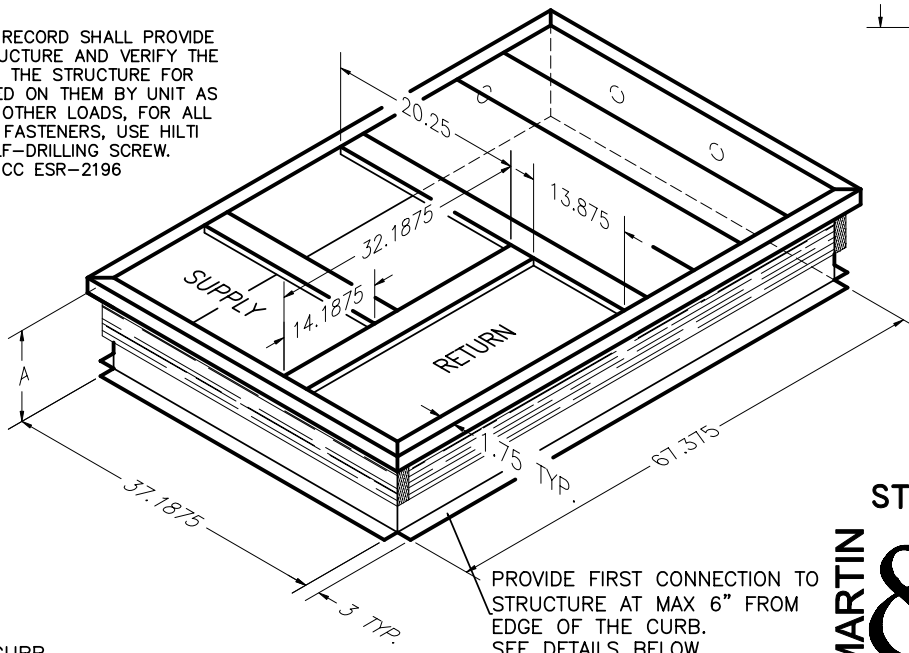

PROVIDE FIRST CONNECTION TO STRUCTURE AT MAX 6" FROM EDGE OF THE CURB. SEE DETAILS BELOW.

STRUCTURAL REVIEW BY:



JOHN A. MARTIN AND ASSOCIATES
 Structural Engineers
 950 South Grand Ave., 4th Floor
 Los Angeles, California 90015
 Phone (213) 483 6490
 Fax (213) 483 3084
 Job No.: 13001

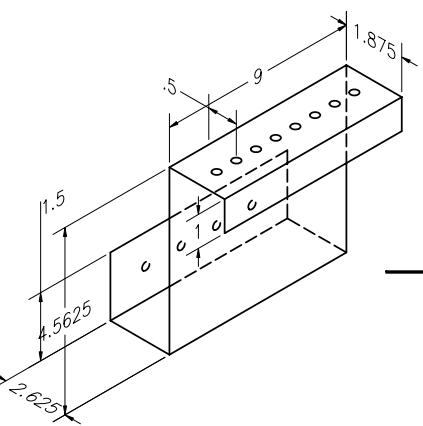
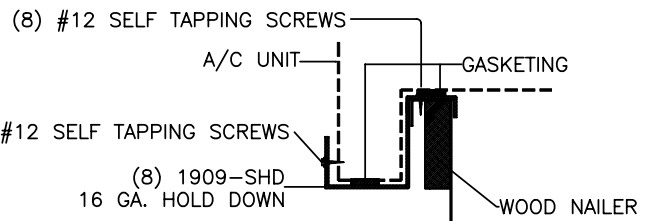

ATTACHMENT TO WOOD

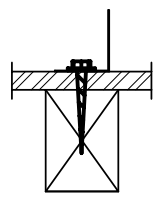

(16) 3/8"x4" LAG SCREWS, HALF EACH LONG SIDE.
 (8) 3/8"x4" LAG SCREWS, HALF EACH SHORT SIDE. CENTER ON CURB BOTTOM.

ATTACHMENT TO STRUCTURAL CONCRETE

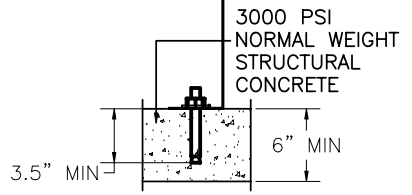

(6) 1/2" HILTI KWIK BOLT TZ, HALF EACH LONG SIDE.
 (4) 1/2" HILTI KWIK BOLT TZ, HALF EACH SHORT SIDE. CENTER ON CURB BOTTOM. (ICC-ES ESR-1917)

ATTACHMENT TO STRUCTURAL STEEL

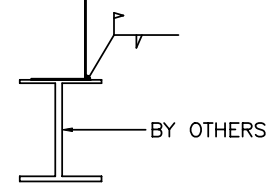

1/8" FILLET WELD. 2" LONG, 48" ON CENTER. PROVIDE MIN 2 CONNECTIONS EACH SIDE

SCALE: NTS



182 GRANITE STREET, SUITE 101, CORONA, CA 92879
 PHONE: (951)278-1830 FAX: (951)278-8444 www.canfab.com canfab@canfab.com

DAY & NIGHT 3 - 6 1/2 TON RAH 36-60, RAS 36-72, RGH 36-60, RGS 36-72, RHH 36-60, RHS 36-72

PART NO: SEE ABOVE	PROJECT
DRAWING NO:	DATE:
APPROVED BY:	DATE: / /



CANNON FABRICATION INC

182 GRANITE STREET, SUITE 101, CORONA, CA 92879

PHONE: (951)278-1830 FAX: (951)278-8444 www.canfab.com canfab@canfab.com

DAY & NIGHT 3 - 6 1/2 TON

RAH 36-60, RAS 36-72, RGH 36-60, RGS 36-72,

RHH 36-60, RHS 36-72

PART NO: SEE BELOW

PITCHED ROOF CURB DRAWING MUST ACCOMPANY ALL PITCHED CURB ORDERS

(A)

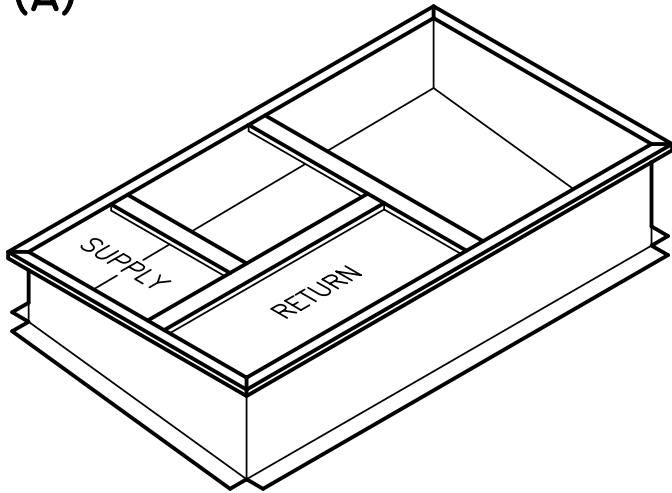

(B)

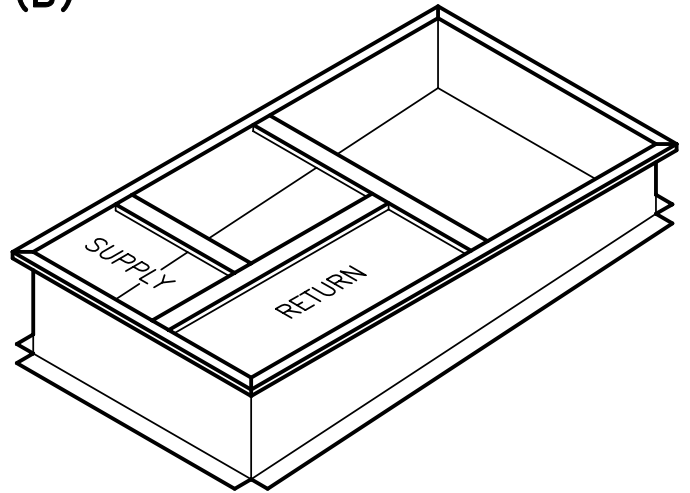

(C)

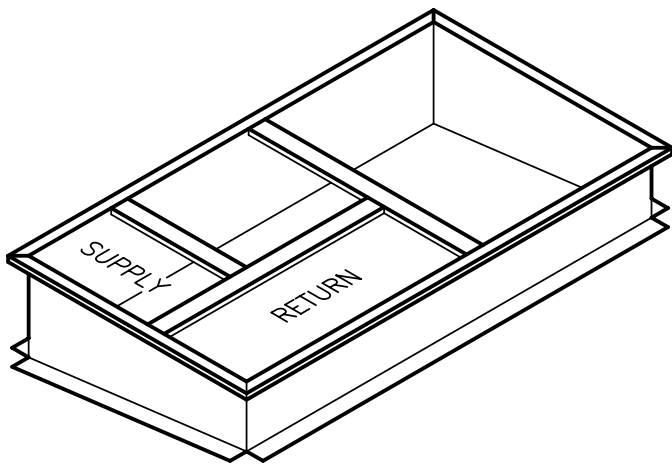

(D)

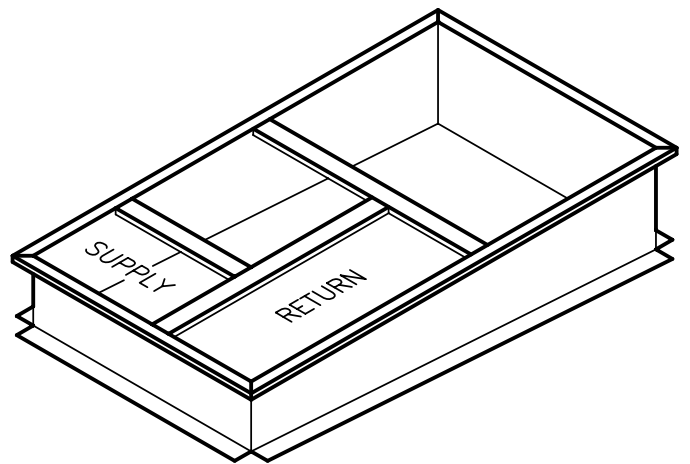

ON 12"

(CIRCLE A, B, C OR D TO SPECIFY DUCT PLACEMENT)

DOC: 01-09

PROJECT:

DATE:

ENGINEER:

DISTRIBUTOR:

DRAWING NUMBER: