



Owner's Manual for models:

Horizontal Bottle Coolers EBC37, EBC50, EBC65, EBC80, EBC95

A Step Above the Standard



Thank you for choosing EVEREST



WARNING - When using your appliance, always follow basic precautions, including the following :

When installing the unit, be careful that the electrical cord is not under the unit or pressed against the wall. This could cause a damage to the cord.

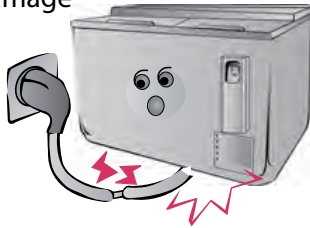

Before starting the unit for the first time, make sure the unit is free from all packaging. Packaging left on the unit during operation may cause a fire hazard.



To prevent electrical shock, please do not plug or unplug the cord with wet hands.

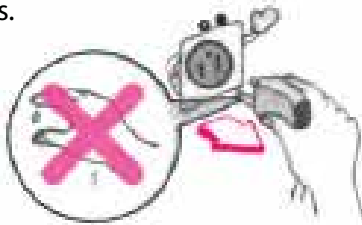

Before cleaning or maintaining the unit, please unplug it. Do not use any flammable cleaning products on or around the unit.

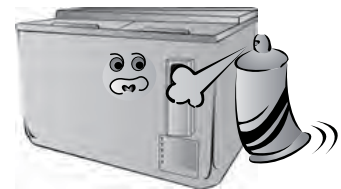

Install the unit on a hard and level surface.



Please do not hang or climb on the unit as this may cause the unit to fall.



Please do not store temperature sensitive items in the unit, such as medical or science research related materials.



If you suspect a refrigerant leak, unplug the unit and immediately contact an authorized service technician.





WARNING - Read and follow all safety notices in this installation guide. These notices provide helpful safety and efficient operation information. Failure to do so may lead to serious injury and / or damage to the unit.

To minimize shock and fire hazards, be sure not to overload the outlet into which the unit is plugged into. A dedicated circuit of sufficient amperage is required.



To prevent damage to the electrical components, have the unit plugged in directly to its own circuit. EVEREST is not responsible for any damage caused by improper electrical connections resulting from electrical power failure, use of extension cords & surge protectors, and any voltage drops to the unit.

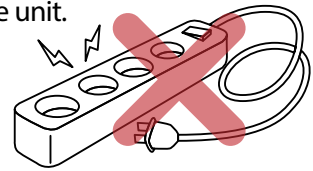

To prevent electrical shock and malfunction, do not spray the unit with water.

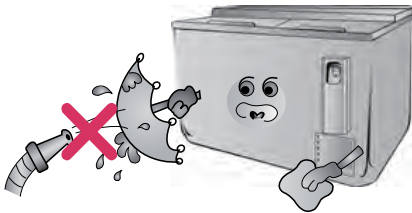

Clean the pronges of the electrical plug with a soft cloth or brush before plugging it into an electrical receptacle to prevent a fire hazard.



When it is time to salvage the unit, make sure to remove the the doors to prevent the risk of children or animals getting trapped inside the unit.



To prevent electrical shock and damage to the electrical cord, please hold the plug head when plugging and unplugging the unit.



Do not use the electrical cord or plug if they are damaged in any way.



To avoid personal injuries from broken glass, please do not place glass items in the freezer.



Avoid installing the unit where it could be exposed to water or moisture.



After unplugging the unit, please wait at least 6 minutes before re-plugging it in. Failure to do so could cause extensive damage to the compressor.

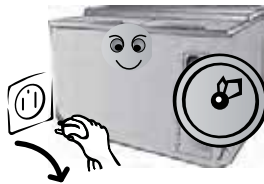

Please do not attempt to remove or repair any components unless you are an authorized service technician.

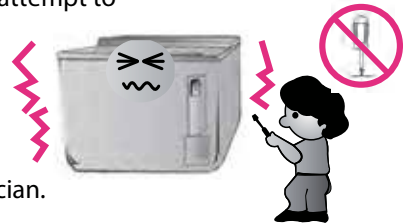

If the unit will not be used for an extended period of time, please unplug it from the outlet.

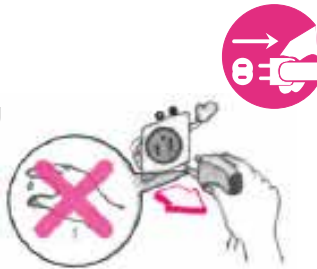

Do not put your hands under the unit when moving it. You could be injured by sharp edges, protruding parts, crushing, etc.



The refrigerator compartment temperature should be set at 32F°~42F°(See page 9). Setting the temperature out of the recommended ranges will void the unit's warranty.

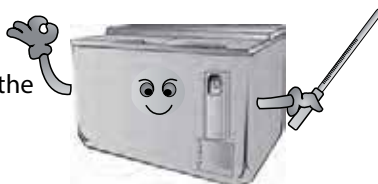

Install the unit on a hard and level surface or the unit could produce undesired noises.



The unit should be at least 2" away from the wall.

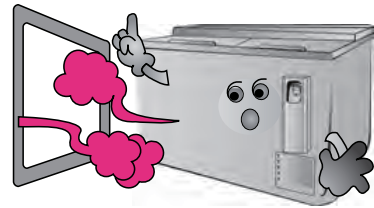

Indoor Use Only

Outdoor use may cause a decrease in performance and significant damage to the unit.



Dusty and High Humidity Areas

Dusty environments will cause the condenser coil to prematurely clog which will require it to be cleaned more often. High humidity environments could cause the unit to rust.

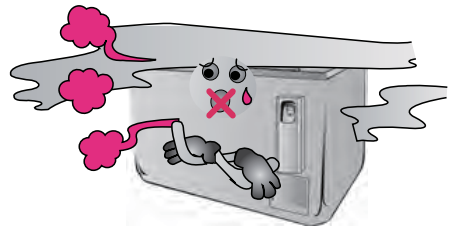

Do not build an enclosure or cabinet around the unit.

Restricting the airflow around the unit's condenser area will cause the compressor to work harder, which can result in compressor failure and the unit not being able to maintain the desired temperature.

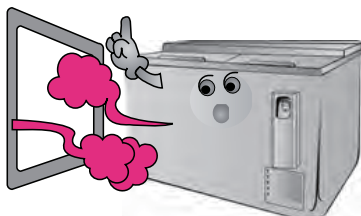

Select a location away from other heat and moisture generating equipment such as stoves, ovens, dish washers, etc.

High ambient temperatures cause the compressor to work harder, which can result in compressor failure and the unit not being able to maintain the desired temperature.



Shelf Cleaning

Periodically remove the shelves from the unit and clean them with mild soap and warm water.



Do not use the following products when cleaning

Clean the exterior of the product with mild soap and warm water. Never use steel wool, strong acids, abrasive cleaners or degreasers. Acidic products and products containing vinegar must be stored in sealed containers to prevent acid damage to the interior of the unit and the evaporator coil. (Rust resulting from the lack of or improper maintenance will not be covered under warranty.)

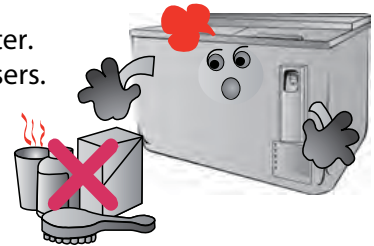

Interior Cleaning

Clean the interior surface of the unit with mild soap and warm water. Do not let water accumulate inside the unit. To prevent water damage, wipe the interior of the unit with a dry cloth as needed. Do not use abrasive cleaners, concentrated detergents, bleaches, cleaning waxes, solvents or polishes to clean the interior of the unit.

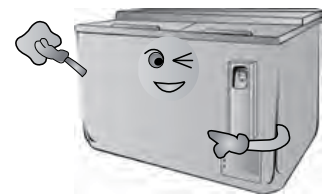

Condenser Coil Cleaning

Poor condensing unit performance is caused by heavy dust build-up on the condenser coil. The condenser coil should be cleaned monthly. Shine a flashlight through the condenser coil to check for dirt between the fins. Clean the outside of the condenser with a soft brush or a vacuum with a brush attachment. The condenser coil should be cleaned in the direction of the fins, top to bottom, not side to side. Be careful not to bend the fins.

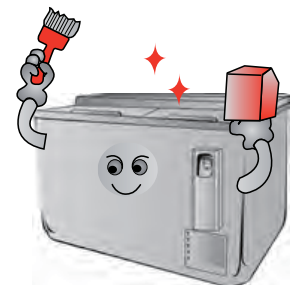

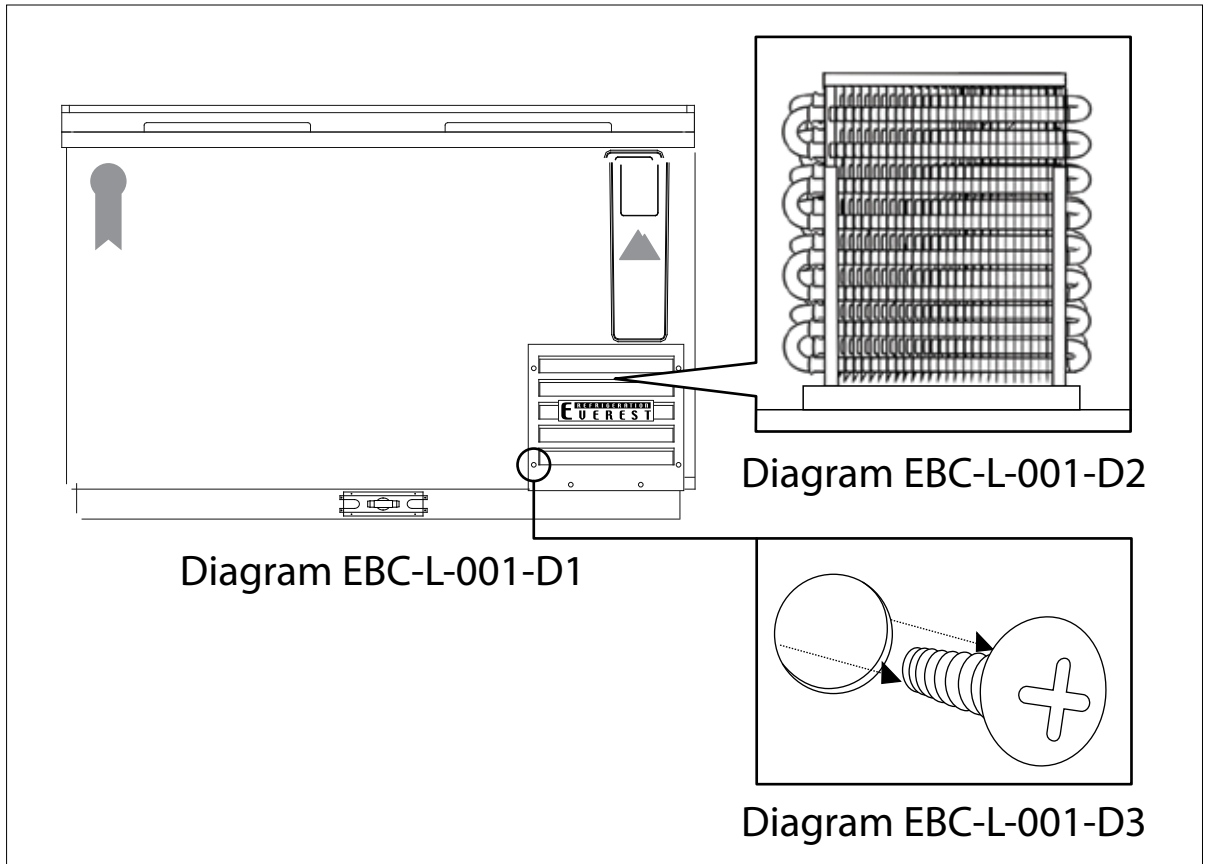

EBC Series

Applicable Model Prefix: EBC/EGC

Model Shown: EBC50









IMPORTANT: Failure to clean the condenser coil will result in a void of warranty.

Follow these simple steps at least once a month to ensure the proper operation of your Everest product.

1. Always unplug the unit before performing maintenance.
2. Locate the condenser coil at the front, right side of the unit. See diagrams EBC-L-001-D1 and EBB-L-001-D3.
3. Unscrew the front grill completely. See diagrams EBC-L-001-D1 and EBC-L-001-D2
4. Use any hard bristled brush in a vertical sweeping motion to remove lint, dust and debris from in between the aluminum fins of the condenser coil. Do not apply heavy pressure so as not to bend the fins*.
5. For grease-coated fins, use any commercial condenser coil cleaner*. Please follow the specific instructions on the bottle.
6. Repeat steps 4 to 5 until fins are clear of any blockage from lint, dust or grease.

* Do not use vacuum brush attachments and abrasive, acid-based cleaners or degreasers to avoid damage to the aluminum fins.

Please check the following before requesting service.

	Symptom	Possible Solutions
	Condensing unit fails to start	a. Ensure the electrical cord has been connected. b. Ensure the unit is turned on.
	Cabinet does not maintain proper temperature	a. Check the door gaskets for proper seal. b. Check to see if the temp. control setting is too high, then adjust as necessary. c. Avoid installing the unit next to heat generating equipment and direct sunlight. d. Avoid storing hot contents. e. Ensure the doors are fully closed.
	Refrigerated compartment is too cold	a. Adjust the temperature control to a warmer setting.
	Noisy operation	a. Check for loose parts. b. Check for tubing rattle. c. Check for a bent fan blade. d. Check for damaged fan motor bearings. e. Ensure the unit is stable. f. Ensure the cabinet is level.
	Condensation on the exterior surface	a. Condensation on the exterior surface of the unit is perfectly normal during periods of high humidity. b. Check door alignment and gaskets for proper seal.
	Sound of water dripping	a. This is the sound of the refrigerant circulating during the compressor rest period and it is normal.
	Exterior walls are warm	a. Heaters have been placed around the door openings to prevent condensation buildup. This is normal.
	Condensation on the interior	a. Condensation can occur during hot and humid weather with frequent or prolonged door opening. This is normal. b. The doors might not be closed properly.



[Ratchet Lock Installation]



Ratchet lock Assembly

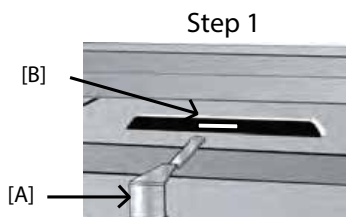

Insert the ratchet [A] into the hole [B] of the door handle.

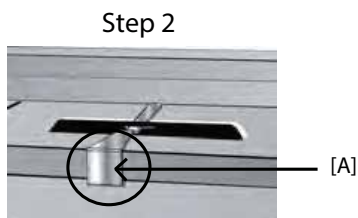

Push the ratchet [A] all the way in until it is fully attached to the surface of the product.

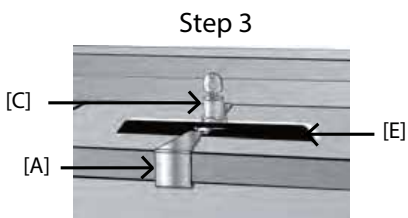

Insert the lock [C] into the ratchet [A] until the lock [C] hits the door handle [E]. Then turn the key to lock it.

[Shelves Installation]

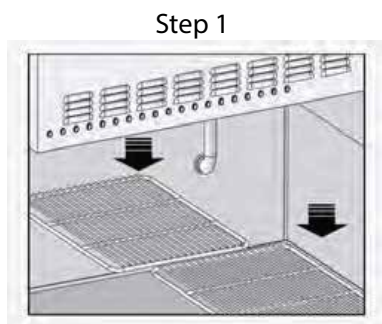

Place the bottom shelves on the cabinet floor.

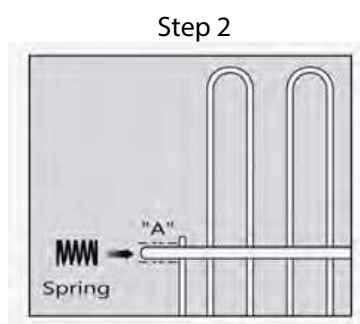

Fit the spring into the partition shelf marked "A".

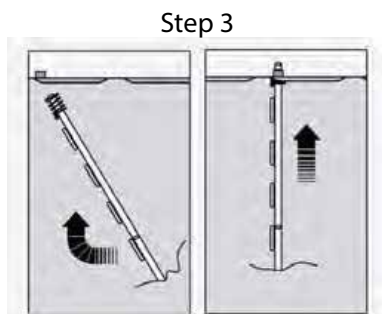

Picture 1

Picture 2

Insert the partition shelf at a 45 degree angle so that the spring fits into the hole located at the back wall as shown in Picture 1.

Push the shelf towards the back wall and align the other end of the shelf in place so that it firmly stands vertically as shown in Picture 2.

Specifications



EVEREST
REFRIGERATION

Model	EBC37	EBC50	EBC65
Capacity(Cu.Ft.)	9.30	13.60	18.90
Door	1	2	2
# of Bin Dividers	2	3	4
# of Floor Shelves	1	2	2
Compressor (HP)	1/4+	1/4+	1/4+
Power (V-Hz-Ph)	115-60-1	115 -60-1	115-60-1
Temp. Range(F)	32 ~ 42	32~ 42	32 ~ 42
Refrigerant	R-134A	R-134A	R-134A
Crated Weight(LBS)	204	245	286
Amps(A)	4.20	4.20	4.20
Dimensions (W x D* x H inches)	36 3/4 x 26 3/4 x 33 5/8	49 1/2 x 26 3/4 x 33 5/8	64 5/8 x 26 3/4 x 33 5/8

Model	EBC80	EBC95
Capacity(Cu.Ft.)	24.40	29.60
Door	3	3
# of Bin Dividers	5	6
# of Floor Shelves	3	3
Compressor (HP)	1/3	1/3
Power (V-Hz-Ph)	115-60-1	115 -60-1
Temp. Range(F)	32 ~ 42	32~ 42
Refrigerant	R-134A	R-134A
Crated Weight(LBS)	348	428
Amps(A)	5.30	5.30
Dimensions (W x D* x H inches)	80 1/2 x 26 3/4 x 33 5/8	95 1/8 x 26 3/4 x 33 5/8

*Depth does not include bottle cap opener with integrated cap receptacle.

Specifications subject to change without notice.

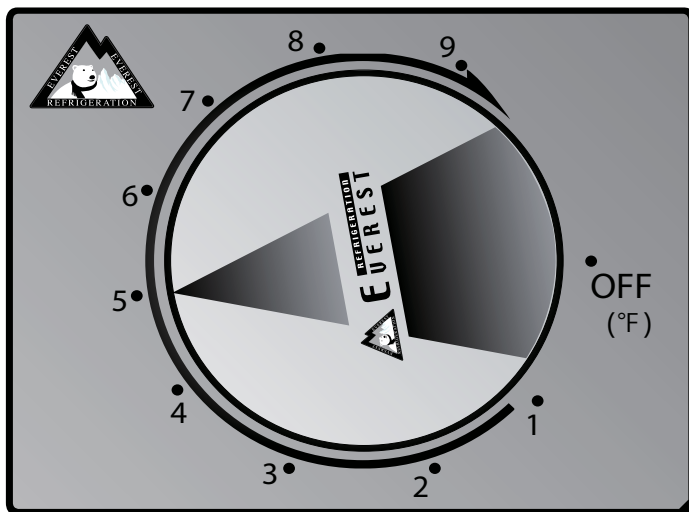

[Temperature Setting Range]

Setting Range	Comp.	REF (°F)
1 ~ 3	On	48
	Off	41
3 ~ 5	On	39
	Off	31
6 ~ 9	On	30
	Off	21

• Factory Recommended Setting: "5"

★ 3/4" O.D.
 T-Shaped PVC
 Drain Fittings w/
 Moveable Plug

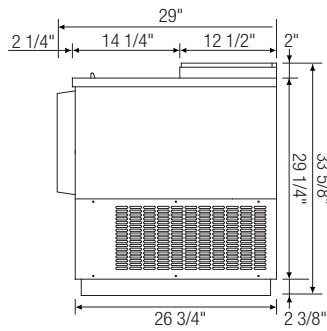

SIDE VIEW

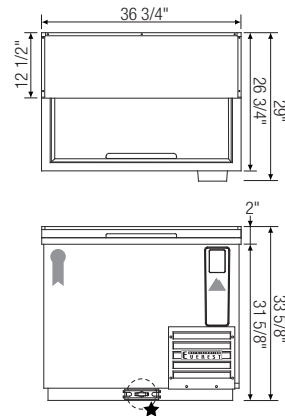

EBC37

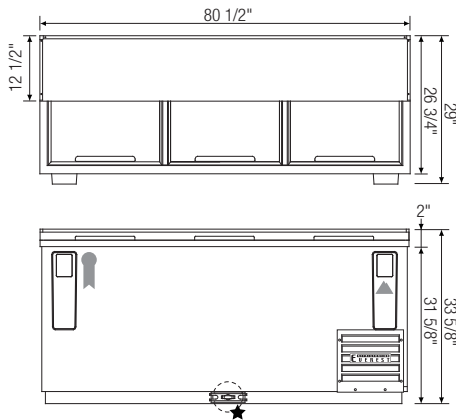

EBC80

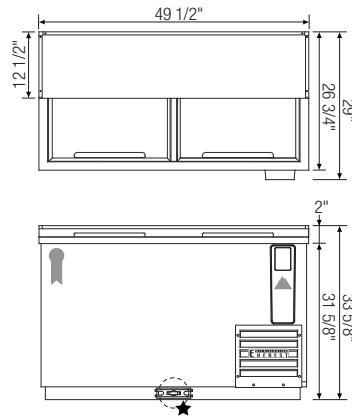

EBC50

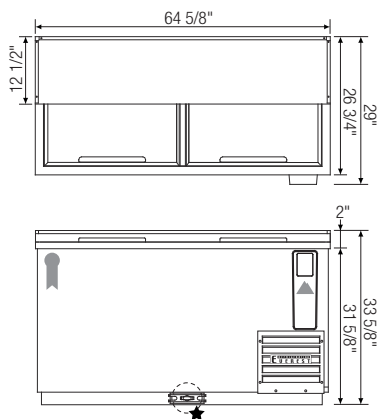

EBC65

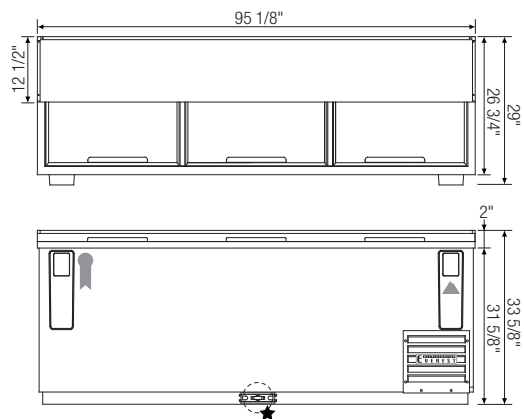

EBC95



The warranty card below must be submitted to Everest within thirty (30) days of purchase.

WARRANTY REGISTRATION CARD

Business Name : _____ Telephone : () _____

Address : _____

City : _____ State : _____ Zip : _____

Place of Purchase : _____ Date Purchased : _____ Date Installed : _____

Model No : _____ Cabinet Serial No : _____

3* YEAR PARTS and LABOR WARRANTY

(Applicable to units purchased after July 1, 2014.)

5 YEAR COMPRESSOR WARRANTY

Name of Business Owner : _____ Date : _____

Signature of Business Owner : _____

** Terms may vary. Contact Everest for further details.*



EVEREST LIMITED WARRANTY

EVEREST warrants to the original purchaser of every new EVEREST unit, the cabinet and all parts thereof, to be free from defects in material or workmanship, under normal and proper use and maintenance service as specified by EVEREST and upon proper installation and start-up in accordance with the instruction packet supplied with each unit. Our obligation under this warranty is limited to a period of three (3)* years from the date of original installation or thirty six (36)* months after shipment date from EVEREST, whichever occurs first (applicable to units purchased after July 1, 2014). Any part covered under this warranty that is determined by EVEREST to have been defective within three (3)* years of original installation or thirty six (36)* months after shipment date from the manufacturer, whichever occurs first, is limited to the repair or replacement, including labor charges, of defective parts or assemblies. The labor warranty shall include standard straight time labor charges only and reasonable travel time, as determined by EVEREST.

WARRANTY CLAIMS

All warranty claims for labor or parts must be made directly through EVEREST. All claims shall include: unit model number, cabinet serial number, proof of new product purchase, installation date, and all pertinent information related to the reported defect. For compressor warranty claims, the compressor tag shall be returned to EVEREST along with the above listed information.

WARRANTY EXCLUSIONS

EVEREST's sole obligation under this warranty is limited to either the repair or replacement of parts, subject to the additional limitations below. This warranty neither assumes nor authorizes any person to assume obligations other than those expressly covered by this warranty.

- A. **NON WARRANTY PARTS.** EVEREST excludes specific parts exposed to normal wear and tear. These parts include, but are not limited to, lamps, gaskets, casters, shelves and shelf clips, pans, bin and pan dividers and airflow guards.
- B. **INDIRECT OR CONSEQUENTIAL DAMAGE.** EVEREST does not warrant economic loss, profit loss, or special, indirect or consequential damages including without limitation, losses or damages arising from food or product spoilage claims caused by refrigeration failure.
- C. **IMPROPER USAGE.** EVEREST is not responsible for parts or labor coverage for component failure and or other damages resulting from improper usage, installation or failure to clean and/or maintain the unit as set forth in the user's manual provided with this unit. All EVEREST units are designed for commercial use, not for residential use. Warranty is invalid if the unit is installed in a residence.
- D. **WARRANTY IS NOT TRANSFERRABLE.** Warranty is limited to only the original purchaser/user to which the unit was delivered. Warranty does not transfer with change of ownership.
- E. **ALTERATION, NEGLIGENCE, MISUSE, ABUSE, ACCIDENT, DAMAGE DURING TRANSIT OR INSTALLATION, FIRE, FLOOD, ACTS OF GOD.** EVEREST is not responsible for malfunctions due to alteration, neglect, misuse, abuse, accident, damage during transit or installation, fire, flood, storm, and/or other acts of God. EVEREST is not responsible for any improper electrical connections resulting from electrical power failure, the use of extension cords, and low voltage or voltage drops to the unit.
- F. **UNAUTHORIZED MODIFICATION.** EVEREST is not responsible for the repair or replacement of failed or damaged components resulting from unauthorized modifications to units or the use of non-standard parts without prior written approval from EVEREST.
- G. **OUTSIDE THE U.S.** This warranty does not apply to any parts and/or labor warranty claims made on units sold or used outside of the United States.

FIVE (5) YEAR COMPRESSOR WARRANTY

In addition to the warranty set forth above, EVEREST warrants the hermetically sealed compressor for five (5) years, not to exceed sixty (60) months from the unit's date of shipment from EVEREST. To qualify for a compressor warranty claim, the replacement compressor must have been purchased directly from EVEREST. Claimants must submit the compressor warranty form, original compressor and electrical components to EVEREST. Additionally, examination by EVEREST must confirm the compressor and electrical components to be defective as claimed. This compressor warranty does not apply to shipping and labor costs or other parts whether electrical or mechanical.

These warranties are exclusive and in lieu of all other warranties, expressed or implied, and all other obligations or liabilities on our part, and we neither assume nor authorize any other person to assume for us any other obligation or liability in connection with the sale of said refrigeration units or any part thereof.

** Terms may vary. Contact Everest for further details.*





REFRIGERATION
EVEREST



A Step Above the Standard

201 W. Artesia Blvd., Compton CA 90220

Tel : 310-323-6586, 800-444-6285

Fax : 310-323-7524, 310-761-1127

Visit our website at www.EVERESTref.com