





SUBMITTAL DATA

3VIR12HP230V1AH / 3VIR12HP230V1BO
12000 BTU/H Wall Mounted Heat Pump System

Job Name		Location	Date
Purchaser		Engineer	
Submitted to		For	
Unit Designation		Schedule No.	

			
YAP1F7F	3VIR12HP230V1AH	3VIR12VHP230V1BO	XE71 (Optional)

GENERAL FEATURES

- AHRI Certificate: [210278970](#)
- High Efficiency DC Inverter Technology
- Compact and Quiet Design
- Auto-Clean Function on Indoor Unit
- Wireless Remote with LCD Display
- Wired Controller Options
- Wi-Fi Included (Factory Installed)
- Low Ambient Cooling down to -20°F (Range -20°F to 122°F)
- Low Ambient Heating down to -22°F (Range -22°F to 86°F)
- Coil (Indoor and Outdoor) Copper Tube / Aluminum Fin
- Blue Colored Fin - 500 Hrs Salt Spray Tested

SPECIFICATIONS, FEATURES & FUNCTION SUMMARY

SPECIFICATIONS		3VIR12HP230V1AH / 3VIR12HP230V1BO		FEATURES & FUNCTIONS SUMMARY		3VIR12HP230V1AH / 3VIR12HP230V1BO	
System Type		HEAT PUMP					
SYSTEM PERFORMANCE				SYSTEM FEATURES			
Cooling	Min - Max	Btu/h	3071 - 14098	Inverter Type	G10		
	Capacity @95°F	Btu/h	12000	Ultra Low Frequency Torque Control	Yes		
Heating	Min - Max	Btu/h	3071 - 15501	Power Factor Correction	Yes		
	Capacity @5°F	Btu/h		Compressor Type - Inverter	High Efficiency Rotary		
	Capacity @17°F	Btu/h	7000	Basepan With Electric Heater	Yes		
	Capacity @47°F	W	12000	Indoor & Outdoor Fin Coating (Blue Fin)	Yes		
SEER2			24.0	Intelligent Defrosting	Yes		
EER2			12.5	Intelligent Preheating	Yes		
HSPF2			9.0	Low Voltage Startup	Yes		
COP @5°F				Memory/Power Failure Recovery	Yes		
COP @47°F			3.8	Self Diagnosis	Yes		
Cooling Temperature Range		°F	-20 - 122	Wired Controller Interface (XE71 or XK76 optional)	Yes		
Heating Temperature Range		°F	-22 - 86	WiFi Included	Yes		
Refrigerant Type			R410A	NEW! Easy Service Access	Yes		
INDOOR UNIT		3VIR12HP230V1AH		Indoor Fan Type	Crossflow		
Air flow (Min-Max)		CFM	182 - 424	Multi Fan Speeds	7 Speeds		
Sound Pressure Level (Min - Max)		dB(A)	27 - 43	Indoor Unit Display	Yes		
Dehumidification		pt/hr	2.96	Auxiliary Electrical Heater	No		
External Dimensions (WxHxD)		in	32-1/2 × 11-9/16 × 7-3/4	Ventilation (Outdoor Air)	No		
Package Dimension (W x H x D)		in	34-7/16 × 14-3/8 × 10-9/16	REMOTE CONTROLLER FUNCTIONS			
Net Weight		lbs	20.9	NEW! Auto Clean	Yes		
Gross Weight		lbs	25.4	Auto Mode	Yes		
OUTDOOR UNIT		3VIR12HP230V1BO		Auto Fan	Yes		
Compressor Type			GREE G-10 / 2 - STAGE INVERTER	Auto Swing (Horizontal Auto Swing)	Yes		
Sound Pressure Level		dB(A)	52	Auto Swing - 180° (Vertical Auto Swing)	Yes		
External Dimensions (WxHxD)		in	31-5/8 × 21-7/8 × 13-13/16	Clock	Yes		
Package Dimension (W x H x D)		in	34-3/8 × 24-7/16 × 15-11/16	Dry Mode	Yes		
Net Weight		lbs	70.6	Dry Anti-Mildew (X-Fan) Mode	Yes		
Gross Weight		lbs	76.1	Energy Saving Mode	Yes		
REFRIGERANT PIPING				Dirty Filter Alert	No		
Refrigerant Charge - R410A		oz	42.3	Fan Speed Control (7 Speeds)	Yes		
Additional Charge		oz/ft	0.2	I Feel Function	Yes		
Line Set Size (Liquid - Gas) - Flared Connections		in	1/4 - 1/2	Privacy Lock	Yes		
Pre-Charge Length		ft	25	Quiet Mode	Yes		
Pipe Length (Min - Max)		ft	10 - 66	Room Temperature Display	No		
Max. Pipe Elevation		ft	33	Sleep Mode	Yes		
ELECTRICAL				3 Sleep Mode Options	Yes		
Power Supply			208-230V / 1Ph / 60Hz (Powered by the Outdoor Unit)	Timer Mode	Yes		
Voltage Range (Min - Max)		VAC	187 - 253	Turbo Mode	Yes		
Rated Current - Cooling		A	6.3	Display On/Off Control	Yes		
Rated Current - Heating		A	6.7	Freeze Guard Mode	Yes		
MCA		A	10	Power Failure Mode	Yes		
MOCP		A	15				
Suggested Breaker Size		A	10				
Main Power Wire Size		AWG	Per Local Code				
Interconnecting Wire Size		AWG	14 / 4				

DIMENSIONS

INDOOR UNIT

Unit: inch

3VIR12HP230V1AH	
DIMENSIONS	
W	32-1/2
H	11-9/16
D	7-3/4
W1	4-29/64
W2	21-11/32
W3	6-11/16

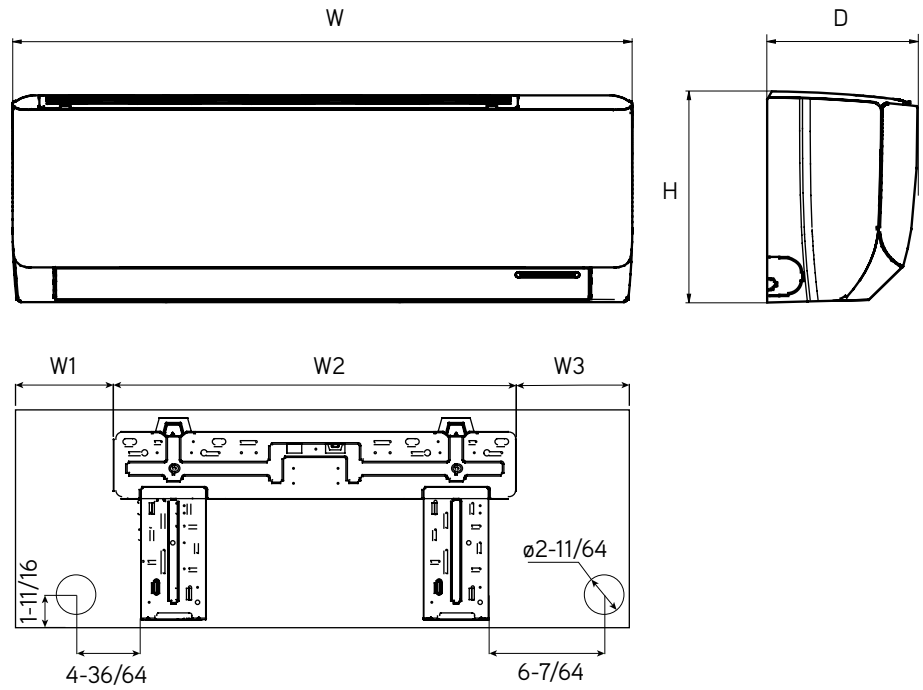

OUTDOOR UNIT

Unit: inch

3VIR12HP230V1BO	
DIMENSIONS	
A	29-21/64
B	31-5/8
C	21-7/8
D	11-13/16
E	13-13/16
F	20-5/32
G	13-5/64

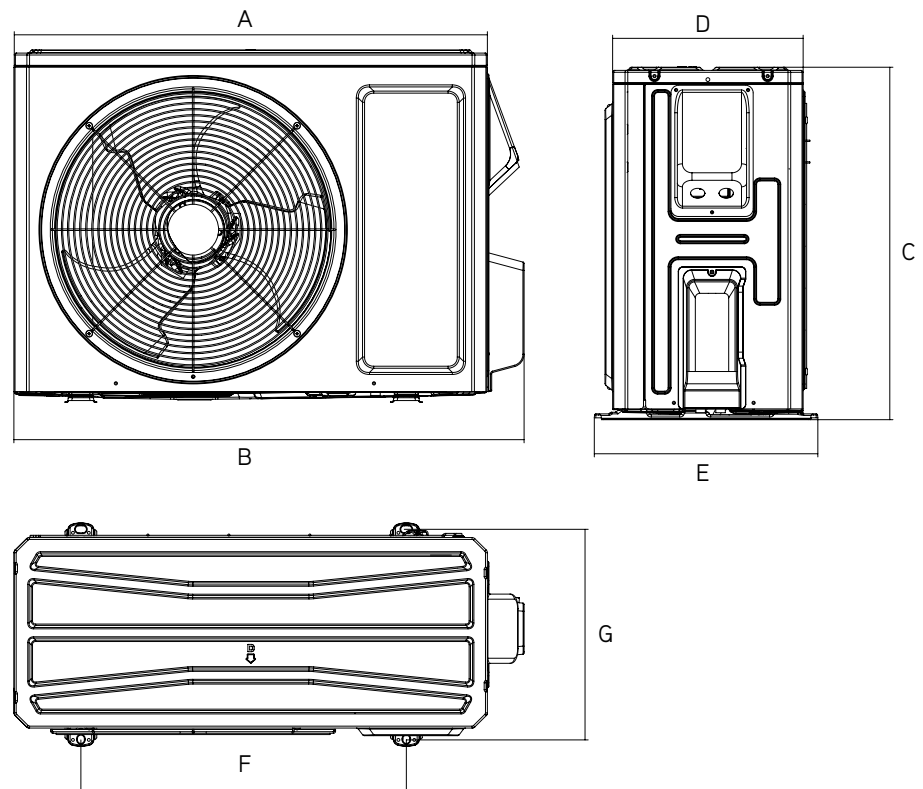

CLEARANCES

INDOOR UNIT Minimum clearance

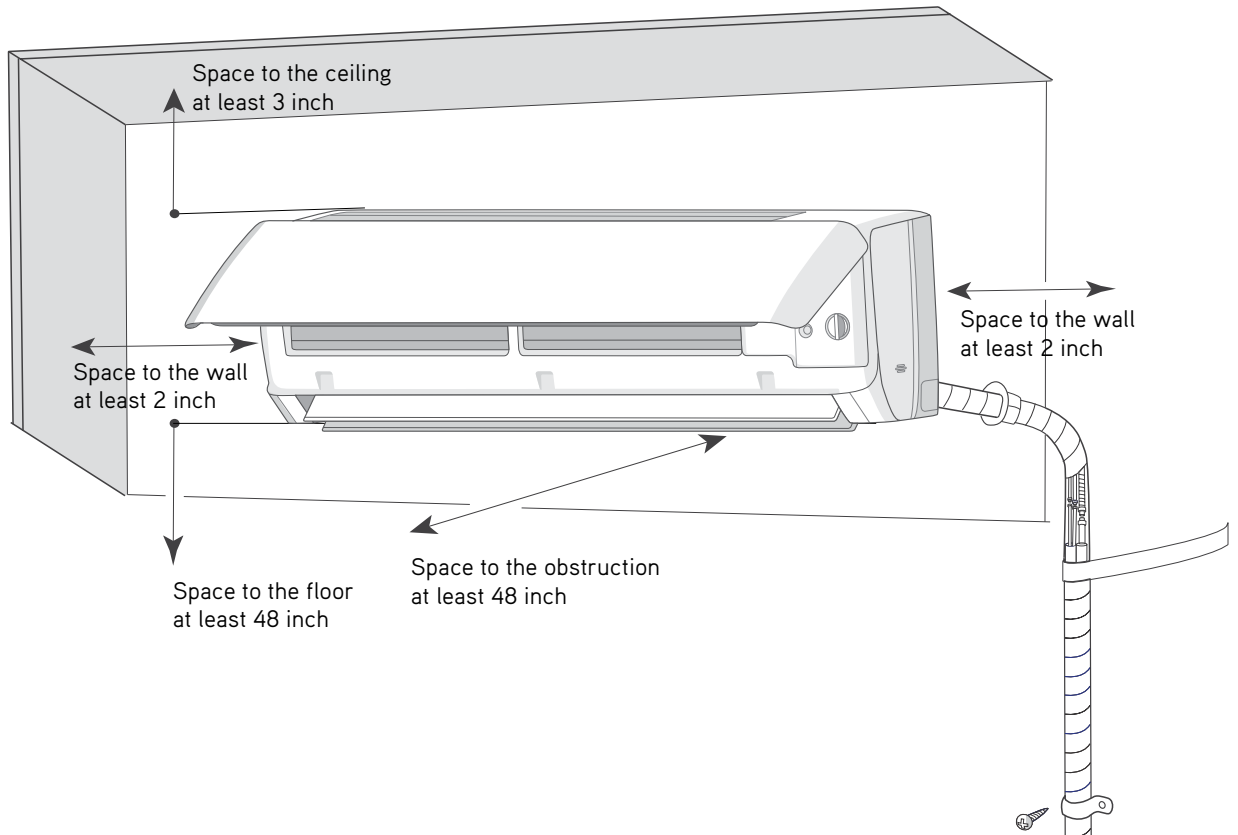

OUTDOOR UNIT Minimum clearance

Diagram illustrating the mounting bracket for the outdoor unit, showing a 1-inch clearance from the wall.

NOTE:
If bottom of the unit is free of airflow obstructions similar to the mounting bracket figure, the clearance to the wall on the back can be reduced to 3 inches.

