

2' X 2' Plastic Lay-In 3 Cone Supply

- PREMIX ABS POLYMER
- WON'T RUST, CORRODE, DISCOLOR, OR FADE
- 4 WAY DEFLECTION
- QUICK CONNECT™ EASY ATTACH CENTER KNOB FOR SIMPLE INSTALL AND REMOVAL
- 3 CONE STEP-DOWN DIFFUSION
- FAST & EFFICIENT CLEANABILITY
- 6", 8", 10" OR 12" PRE-MOLDED INLET BOOT OPTIONS
- STANDARD WHITE OR BLACK

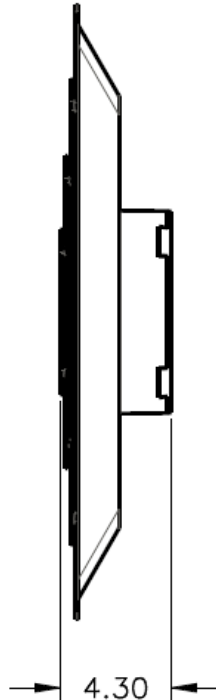
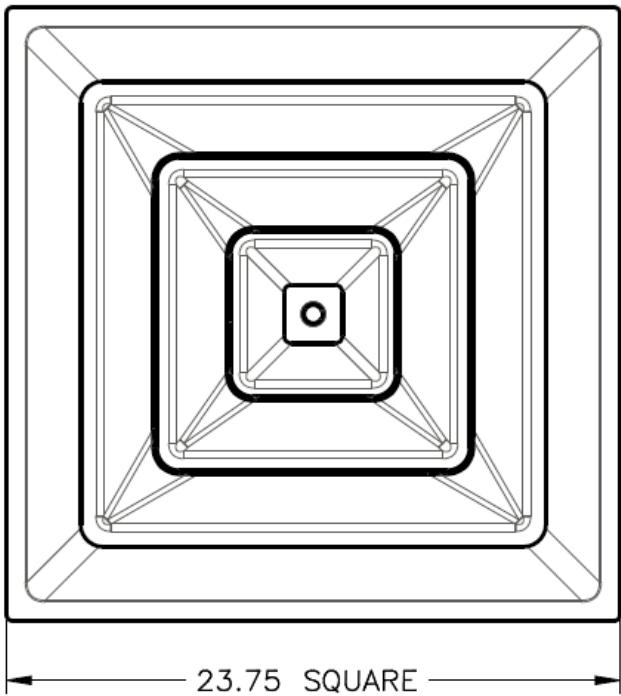

COLOR

- WHITE
- BLACK
- CUSTOM

UL 94HB RATED ABS PLASTIC

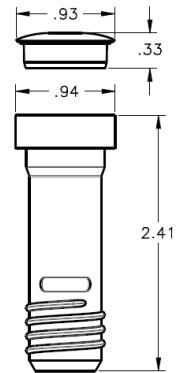

6" HT-2X2-SPL6

8" HT-2X2-SPL8

10" HT-2X2-SPL10

12" HT-2X2-SPL12

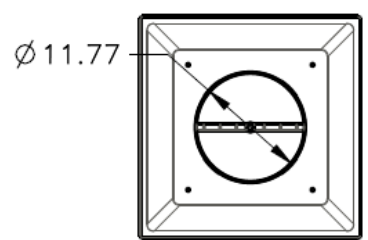
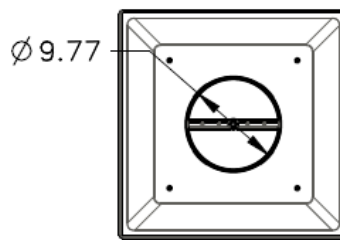
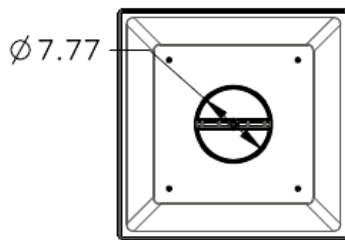
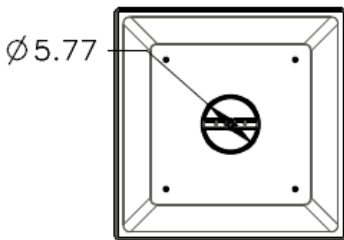

JOB NAME _____

LOCATION _____

ARCHITECT _____

ENGINEER _____

CONTRACTOR _____

SUBMITTED BY

DATE

2' X 2' Plastic Lay-In Bordered Supply

- PREMIX ABS POLYMER
- WONT RUST, CORRODE, DISCOLOR, OR FADE
- QUICK CONNECT™ EASY ATTACH CENTER KNOB FOR SIMPLE INSTALL AND REMOVAL OF DIFFUSER—PATENT PENDING
- FAST & EFFICIENT CLEANABILITY
- 4 WAY , 3 WAY AND 2 WAY DEFLECTION DIFFUSERS AVAILABLE
- 6", 8", 10", 12" OR 14" PRE-MOLDED INLET BOOT OPTIONS
- STANDARD WHITE OR BLACK

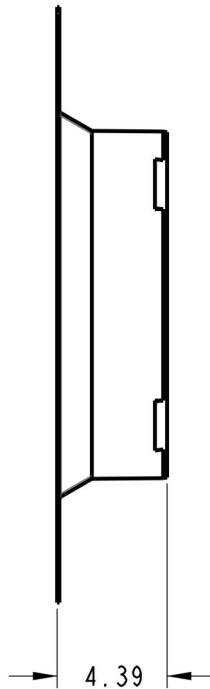
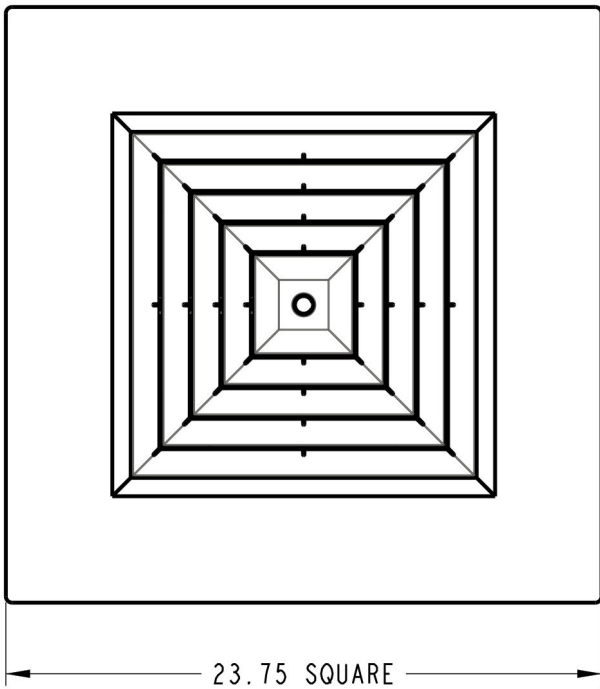

COLOR

- WHITE
- BLACK
- CUSTOM

UL 94HB RATED ABS PLASTIC

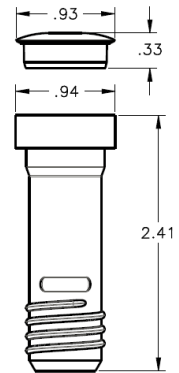

6" HT-2X2-BSPL6

8" HT-2X2-BSPL8

10" HT-2X2-BSPL10

12" HT-2X2-BSPL12

14" HT-2X2-BSPL14

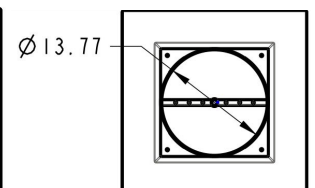
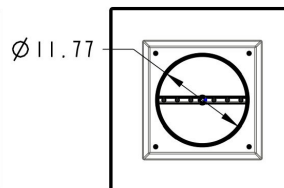
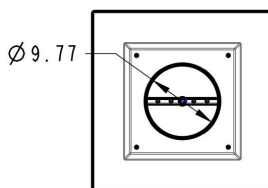
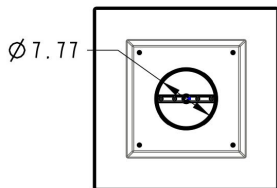
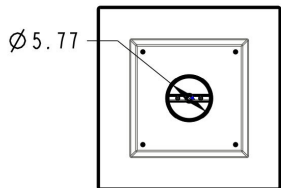

JOB NAME _____
 LOCATION _____
 ARCHITECT _____
 ENGINEER _____
 CONTRACTOR _____

SUBMITTED BY

DATE

2' X 2' Plastic Lay-In Plaque Supply

- PREMIX ABS POLYMER
- WONT RUST, CORRODE, DISCOLOR, OR FADE
- 4 WAY DEFLECTION
- QUICK CONNECT MAGNETIC ENGAGEMENT SYSTEM WITH OVER 24 LBS OF PULL FOR SIMPLE INSTALL AND REMOVAL OF DIFFUSER—PATENT PENDING
- FAST & EFFICIENT CLEANABILITY
- 6", 8", 10", 12" PRE-MOLDED INLET BOOT OR BULLS EYE BACK OPTIONS
- STANDARD WHITE OR BLACK

COLOR

- WHITE
- BLACK
- CUSTOM

UL 94HB RATED ABS PLASTIC

BULLSEYE
HT-2X2-PSPLBE

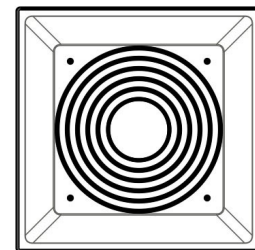
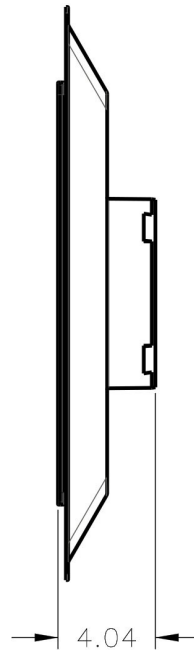
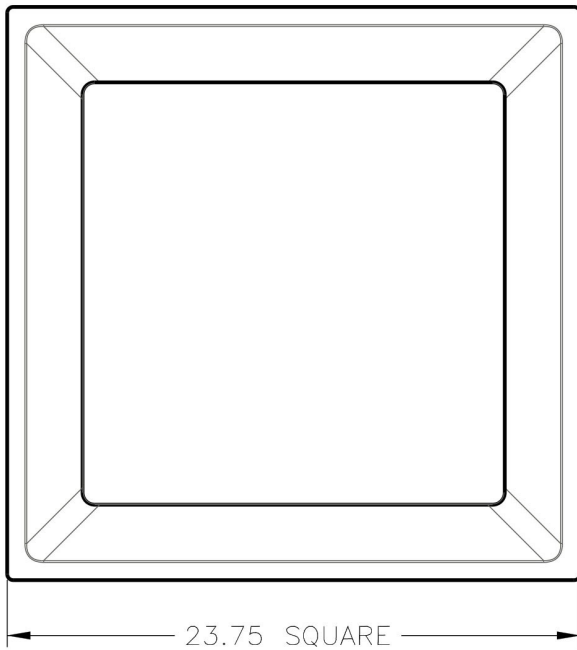

6" HT-2X2-PSPL6

8" HT-2X2-PSPL8

10" HT-2X2-PSPL10

12" HT-2X2-PSPL12

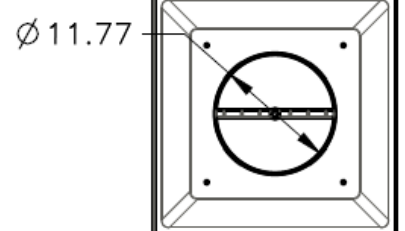
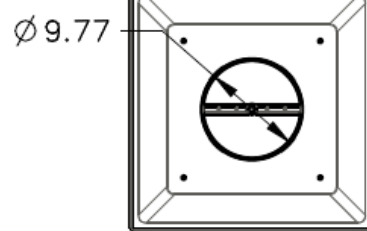
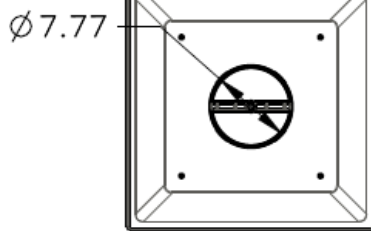
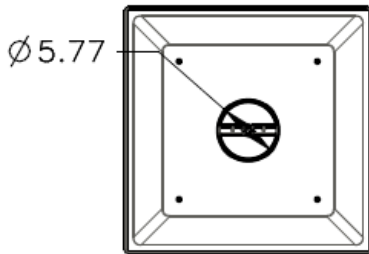

JOB NAME _____

LOCATION _____

ARCHITECT _____

ENGINEER _____

CONTRACTOR _____

SUBMITTED BY

DATE