



F-Style Large Capacity Ice Storage Bins

Models

 F-700

 F-1300

 F-1325

 F-1650

 FC-1350

F-1300 Ice Storage Bin



FC-1350 Ice Storage Bin & Cart System

Standard Features

Manitowoc F-style large capacity ice storage bins are equipped with a sliding ice gate for increased employee safety, easier ice removal, and reduced spillage.

Choose a bin width from 30", 48" or 60", with relative ice storage capacities of 680 lbs., 1320 lbs. or up to 1660 lbs.

Sliding Ice Gate

- Controls ice flow into snout for easy removal with either scoop or shovel
- Returns easily to full down position

Quality Construction

- Stainless steel exterior
- Heavy-duty welded construction
- Non-CFC foamed-in-place insulation
- Impact-resistant sliding windows for easy bin inspection

Durable Polyethylene Lift Door

- Ball catch hinge holds bin door open when scooping ice
- Eliminates sharp corners and gaskets
- Provides outstanding durability
- Offers maximum access for fast, easy ice removal

Warranty

Bin & Accessories: 3-Year Parts & Labor

Carts: 2-Year Parts & Labor





F-Style Large Capacity Ice Storage Bins

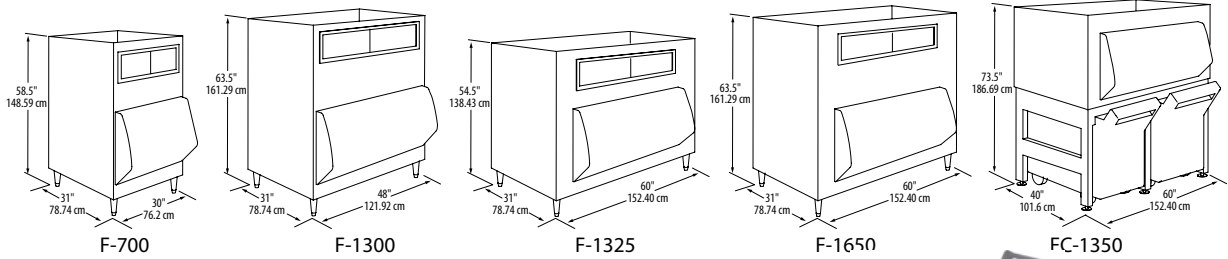

Standard Equipment

F-Series Bins Include: set of (4) 6" bin legs, ice scoop, stainless steel adapter for 30" or 48" Indigo Series Cubers (see chart)

FC-1350 Bin and Cart System Includes: bin, base, (2) 240 lb. capacity carts with lids, set of (6) flanged legs, Ice Paddle, stainless steel adapter for 30" or 48" Indigo Series Cubers (see chart)

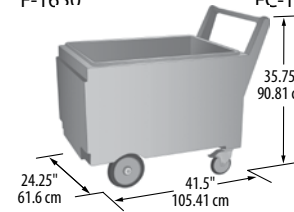

Accessories

- | Model # | Description |
|---------|--|
| K-00412 | Paddle 46.5" (118.11 cm) length |
| 3302593 | 82 oz. Scoop |
| K-00414 | Shovel 36" (91.44 cm) Length |
| K-00416 | Totes Ice Carrier, Set of 6 (25 lb. capacity per tote)
Totes for use with FC-1350 cart. One set of 6 required per cart. |

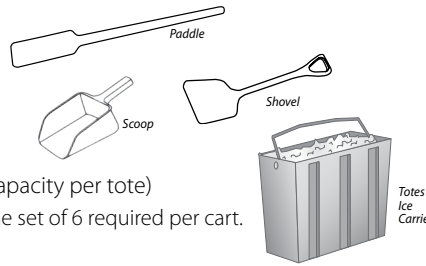

Storage Capacity

	Model	AHRI*	
		Lbs. / kg	Cu. Ft.
30"	F-700	680	20.3
		308	
48"	F-1300	1320	38.0
		599	
60"	F-1325	1325	39.7
		601	
	F-1650	1660	47.7
		753	
	FC-1350	1350	39.9
612			

*AHRI storage capacity for bins is based on 80% of total volume in cubic feet x 30 lb./ft.3 average density of ice.

Ice Deflectors — Required

Manitowoc Cuber Model	Ice Deflector Model Number
i-450, i-500, i-606, i-906, i-1106, i-1200	K-00347
i-1400, i-1800	K-00349
i-1470C, i-1870C, i-2170C	K-00382 (for single ice machine) K-00383 (for side-by-side ice machines)
S-3070C, S-3300	K-00391

Bin Adapters

Bin	Model	Ice Makers on Bin	Ice Machine									
			i-300	i-450	i-500	i-606	i-906 i-1106 i-1200	i-686C i-976C i-1176C	i-1470C i-1870C i-2170C	i-1400 i-1800	RFS-0300 RFS-0650 RFS-1278C RFS-1279R	S-3070C S-3300
Bin	F-700	1	K-303000 Single Head Adapter (Included with Bin)							N/A	K-302200	N/A
	F-1300	1	K-483048 Single Head Adapter (Included with Bin)							N/A	N/A	Adapter Not Required
	F-1325	1	K-603048 Single Head Adapter (Included with Bin)							N/A	N/A	K-604800
		2*	K-603030 Side-by-Side 30" Head Adapter							N/A	K-00421 and K-603030	N/A
	F-1650	1	K-603048 Single Head Adapter (Included with Bin)							N/A	N/A	K-604800
		2*	K-603030 Side-by-Side 30" Head Adapter							N/A	K-00421 and K-603030	N/A
FC-1350	1	K-613048 Single Head Adapter (Included with Bin)							N/A	N/A	K-614800	
	2*	K-613030 Side-by-Side 30" Head Adapter							N/A	K-00421 and K-613030	N/A	

* Only for use with water-cooled and remote ice machines or machines with top air discharge option. Check ice machine clearance requirements.